



TECHNICAL DATA  
FROM  
**Anemostat**<sup>®</sup>  
DOOR PRODUCTS  
A MESTEK COMPANY

1220 E WATSON CENTER RD  
CARSON, CA 90745-4206  
(310) 835-7500 • FAX (310) 835-0448

e-mail: door@anemostat.com • website: www.anemostat.com

**BFL-123**

METAL  
VISION FRAME



UNDERWRITERS'  
LABORATORIES

FIRE  
RATINGS



WARNOCK  
HERSEY

**B.S.-476.22**  
British Standard

DETAIL DRAWING

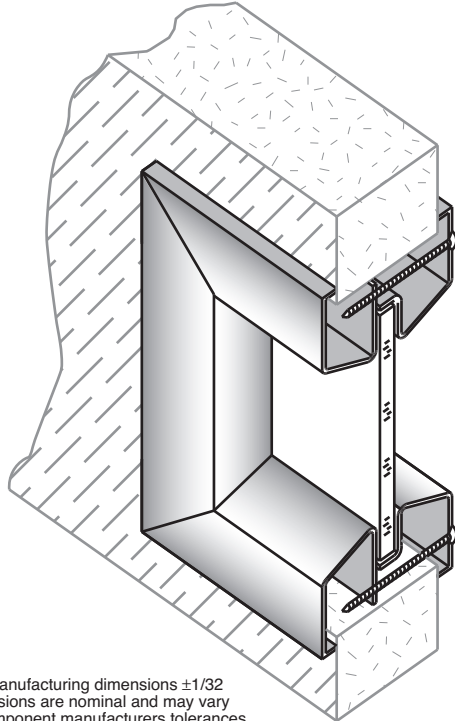

Anemostat manufacturing dimensions ±1/32  
Actual dimensions are nominal and may vary  
based on component manufacturers tolerances.

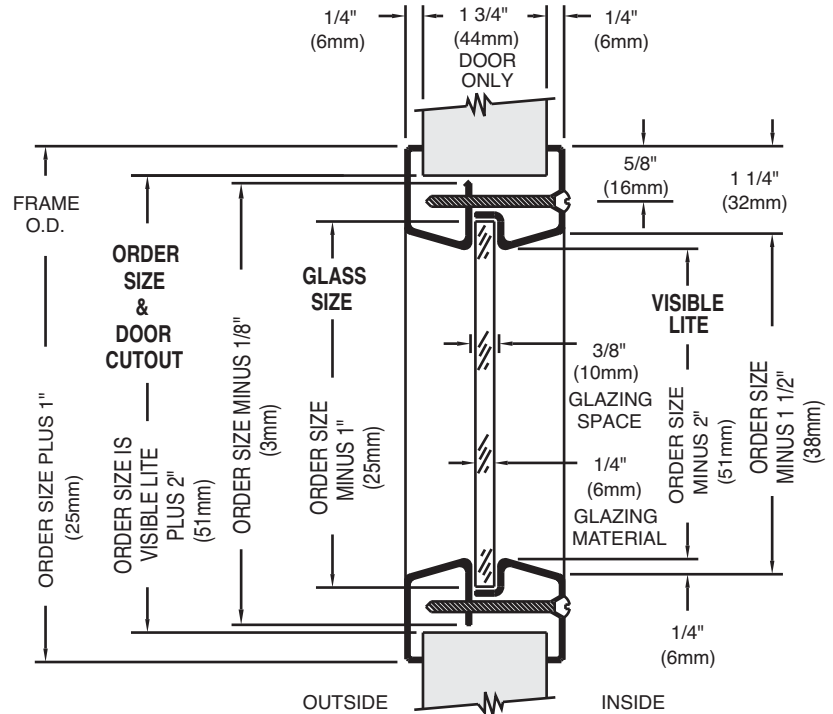

STANDARD PRODUCT FEATURES

- MATERIAL:** 18 GA. (1.25mm) Cold Rolled Steel.
- FINISH:** Grey Primer, Beige or Bronze Baked Enamel.
- INSTALLATION:** Uses 1 3/4" (44mm) sheet metal screws that pass through the door cutout, and fastens to the opposite side of the vision frame, thus eliminating the need to drill the door for thru bolts and saving installation time and labor. It also leaves the corridor side of the frame free of fasteners for added security and a cleaner, more aesthetic appearance.
- DOOR THICKNESS:** For 1 3/4" (44mm) Wood or Metal Doors.
- GLAZING:** Should be 1/4" (6mm) or 3/16" (5mm) fire and/or safety rated with U.L. and/or W.H.I. classification markings. Glazing space of 3/8" (10mm) allows for glazing tape to be used on both sides of the glass.
- AESTHETICS:** Tight mitered corners, beveled glass stop for a clean tapered look.
- IMPORTANT:** Interpretation of building and fire codes may vary. Consult with the local authority having jurisdiction in your area, to determine appropriate standards.
- NOTE:** For Exterior use, High Humidity or Salt Air application, product must be Galvanized or Stainless Steel.
- PLEASE NOTE:** On visible lite sizes larger than 1296 sq. in. (0.836m<sup>2</sup>) on 20/45 min. and 100 sq. in. (0.065m<sup>2</sup>) on 60/90/180 min., please consult with your Door / Frame Manufacturer's procedures, for their maximum glass size tested.

OPTIONAL FEATURES

- MATERIAL:** #304 or #316 Stainless Steel, #4 Finish(Satin), Galvanized (Coil, Hot Dipped, or Zinc Plated).
- FINISH:** Custom Baked Enamel Colors (as per sample chip supplied). Plated Finishes to match the lock, hinges and closer.
- FASTENERS:** Special Security Screw Fasteners, See Page 36, this section.
- SPECIALS:** Fractional Sizes, Lead Lined for X-ray applications, Glass or Door thickness (see FGS-IS or LoPro-IS).
- HM CLIP:** Replaces the need for reinforcing channel in the door cutout, see page 37 this section.

FIRE RATINGS (w/ U.L. & W.H.I. classification markings) Positive Pressure

- 20 MINUTE:**\* Approved listing at 3204 sq.in. (2.067 m<sup>2</sup>) visible lite max. width 36" (914mm), max. height 89" (2261mm).
- 45/60 MINUTE:**\* Approved listing at 2772 sq.in. (1.788 m<sup>2</sup>) visible lite max. width 36" (914mm), max. height 77"(1956mm).
- 90 MINUTE:**\* Approved listing at 1296 sq.in. (0.836 m<sup>2</sup>) visible lite max. width 36" (914mm) , max. height 54" (1372mm).
- 3 Hour:**\* Approved listing at 100 sq.in. (0.065 m<sup>2</sup>) visible lite max. width 12" (305mm), max. height 33" (838mm)

\* Must be used with FIRELITE Plus or NT and Fire listed glazing tape or another manufacturer's equivalent product. Glazing combination must be used in appropriately tested door assembly.

**BS 476.22** Timber Doors - 30 min. and 1 hour.  
British Standard Steel Doors - 2 hours (4 hours actual).

Job Name & Location	Submitted by