

**PENNER**

**DOORS AND  
HARDWARE**

**DISCOVER PENNER**

2025

For 40 years, Penner Doors & Hardware has provided expertise in the specification, fabrication, and distribution of residential, commercial and architectural door and hardware systems - from British Columbia to Western Ontario. Our team is available to provide complete solutions to the challenges of today's door and hardware industry.

## OUR PARTNERS

- General Contractors
- Architects
- Design Builders
- Developers
- Property Management Companies
- Facility Managers
- Institutions
- Custom Home Builders
- Modular Builders
- Security Access Control - Locksmiths



## TABLE OF CONTENTS

---

**4-9****SERVICES**

Penner Doors & Hardware offers estimating and project management for door, hardware and building specialty requirements of all sizes for commercial, industrial and institutional construction projects. We are fully bonded and COR certified.

We provide on-site solutions, specification writing, design consultation, troubleshooting, custom metal fabrication and installation.

Our service technicians work closely with property management companies for on-site installation and remedial work.

---

**12-35****PROJECTS**

Our experienced team recommends products and solutions while meeting budget requirements.

---

**36-87****PRODUCTS**

Mailboxes  
Washroom Partitions & Accessories  
Building Specialties  
White Boards & Tack Boards  
Floor Mats, Grilles & Pet Wash Stations  
Shelving & Moulding  
Bike Racks  
Wall & Ceiling Partitions  
Exterior Doors  
Aluminum Entrances  
Hollow Metal Doors & Frames  
Interior Doors  
Commercial Hardware  
Wall Systems  
Automatic Operators

---

**88****AFFILIATIONS & CONTACT**

---



P

D

**PENNER**  
**EXPRESS**

**Coming Soon**

Online Ordering & Tracking | Quick Turn Fabrication | Direct-to-Site & Rush Delivery Options

[pennerexpress.com](http://pennerexpress.com)





## COUNTER SALES DIVISION

Penner Doors & Hardware is a trusted vendor of the leading door & hardware brands, offering a high-level of knowledge and service.

Phone (1-888-871-3667) or visit one of our locations in Calgary, Edmonton, Red Deer, Saskatoon, or Winnipeg.

### QUICK SHIP

A select listing of Commercial Hardware, Hollow Metal Doors and Frames are ready for pickup or delivery in a matter of hours.

### QUALITY

We sell and distribute for the leading vendors in our industry. Penner Doors & Hardware take pride in staying on top of the newest products and training available.





## CONTRACT DIVISION

### ABOUT US

With 40 years of outstanding service, and locations in Calgary, Edmonton, Red Deer, Saskatoon and Winnipeg, Penner Doors & Hardware offers end to end solutions. We ensure the openings designed for your project are as per your requirements and best suited for the design and budget.

### CONSULTING AND SPECIFICATION WRITING

At the beginning of your project, we write a specification of products for each opening, ensuring your opening designs meet all applicable building code requirements.

### DOOR & HARDWARE SCHEDULE

Optimal door performance begins with an accurate and complete door hardware schedule. Following a standard format the schedule specifies the type of hardware required, while complying with the budget, owner standards, quality level, security level, as well as the fire and building codes within the region of construction.

### PROJECT CO-ORDINATOR

We match our Co-ordinators with your project. Our team members are responsible for assisting with an on-time and on budget completion of your project.

### SHOP DRAWINGS

We provide detailed shop drawings and materials for your project.

## SERVICE & INSTALLATION

### THE PENNER DIFFERENCE

Penner Doors & Hardware installs and services everything we sell. Our certified technicians provide professional installation services for multiple market segments to provide owners, end users and general contractors with the complete customer experience.

### WE SERVICE THE FOLLOWING:

- Automatic / Manual / Revolving / Sliding Doors
- Access Control
- Operable Walls
- Partitions
- Rolling Steel / Fire doors
- Overhead Doors

### INSTALLATION

Our co-ordinators will quote using our in-house crews or align with the leading installers in your area. Our on call personnel have one or more of the following certifications:

- AAADM Certification / DHI Member

#### NEW PRODUCT INSTALLATION

Let us do the work for you! Whether your project is a large multi-phase building like a university dorm, or a one-of-a-kind tenant improvement, we will install our products for you.

#### PLANNED MAINTENANCE

Avoid unpleasant surprises with planned maintenance. An annual check up into your facility can save you time, money and headaches.

#### RETROFITS & RENOVATIONS

Planning a renovation? Penner Doors & Hardware can design and install your commercial, industrial or multi-family needs.





## VALUE ADDED SERVICES

### SPEC WRITING & ESTIMATING

We provide specification writing and estimating at any stage of the project, budget, tender or construction. We specialize in Division 8 and Division 10.



### SHOP DRAWINGS

Available for projects of any size or complexity.

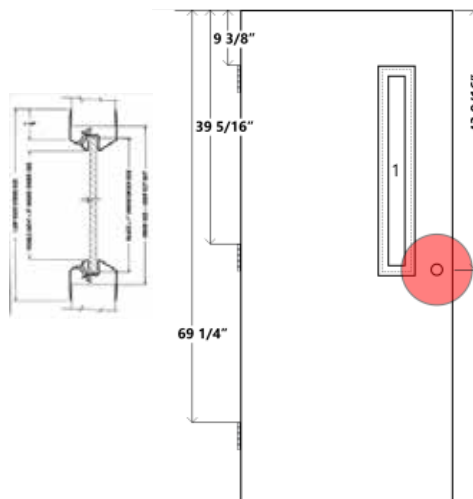

### FABRICATION

Penner offers full service fabrication in four locations, Winnipeg, Calgary, Edmonton and Saskatoon. Our quality and service includes glass installation, hardware preparation, welded frames and borrowed lites.

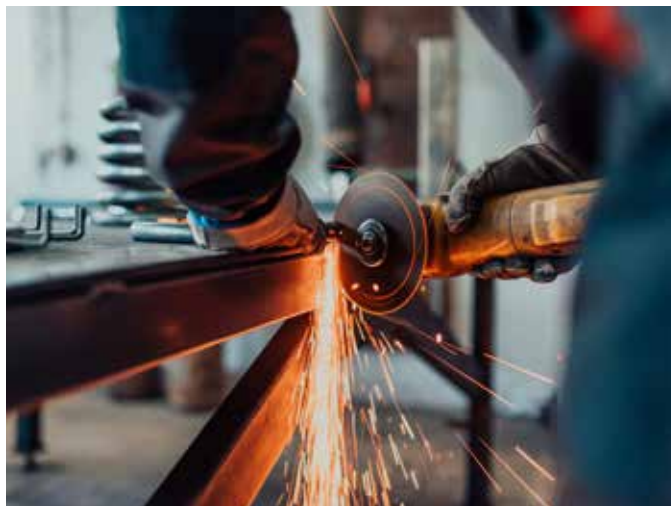

## PRE-FINISHING

The primary goal in construction is on time and on budget. In-house painting and hardware installation ensure you meet your targets.



## HARDWARE INSTALLATION

By utilizing our experienced in-house hardware installers, all doors arrive pre-finished with hardware mounted. No more lost hardware parts or need for on site storage. Issues are resolved before they are delivered.



## PACKAGING & CRATING

Product is labelled for easy identification on site.







**MULTI-FAMILY**

STUDENT HOUSING |





CONDOS | TOWNHOMES | ASSISTED LIVING



## BAYDO TOWERS

LOCATION: SASKATOON, SK

BUILDER: BAYDO CONSTRUCTION

Baydo Towers is a multi use apartment complex located in Saskatoon, Saskatchewan. The project consists of two 25 story towers including a public terrace with BBQ's, meeting rooms, gym, games room, yoga room, dog park, bike storage room and much more.

**SUPPLIED:** Hollow metal doors/frames, suite entry wood doors, interior suite wood doors, mailboxes, hardware for common areas and suites, washroom accessories for common areas and suites.





## THE ARGYLE

LOCATION: CALGARY, AB

BUILDER: HOMES BY AVI

Located in the vibrant, amenity-rich University District, Argyle is an investment-focused residence comprised of 151 spacious, studio, one, two, and three bedroom units, conveniently situated above almost 30,000 sq ft of main-floor retail space.

**SUPPLIED:** Metal doors/frames, door hardware, bike racks, mailboxes, storage compartments.





## SCENIC GRANDE BY REVERA ASSISTED LIVING

LOCATION: CALGARY, AB

BUILDER: CHANDOS CONSTRUCTION

The Scenic Grande Retirement Residence offers state-of-the-art accommodations and luxury amenities.

**SUPPLIED:** Metal and wood doors/frames, hardware, toilet partitions, washroom accessories, lockers, flagpoles, and rolling shutters, including installation.



## HYDE PARK PERSONAL CARE HOME

LOCATION: SASKATOON, SK

BUILDER: QUOREX CONSTRUCTION

Hyde Park Personal Care Home brings together award-winning facility design and compassionate care providers to offer a safe and stimulating environment for aging family member to live comfortably.

**SUPPLIED:** Fire labelled interior suite doors/frames, interior wood doors, hardware, and mouldings.



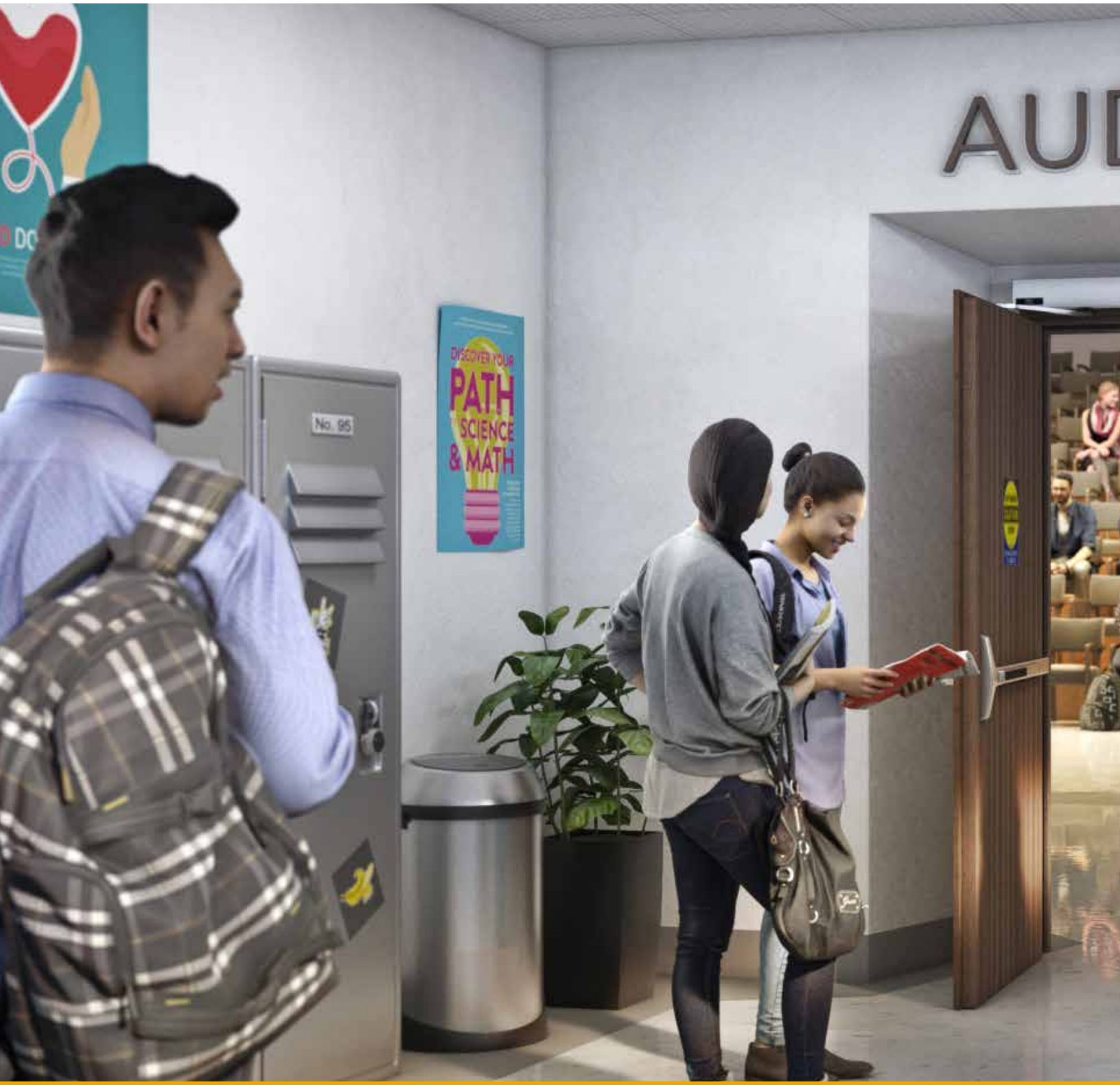

HOSPITALITY

|

HEALTHCARE



# DITORIUM



EDUCATION



OFFICE



## BEARSPAW CHRISTIAN SCHOOL RENOVATION

LOCATION: CALGARY, AB

BUILDER: CARLSON CONSTRUCTION

New addition to Bears paw Christian School in Calgary. This project seamlessly connected two existing buildings, creating modern classrooms and vibrant common areas.

**SUPPLIED:** Metal and wood doors/frames, hardware, toilet partitions, washroom accessories, lockers, flagpoles, and rolling shutters, including installation.



## FFCA MONTGOMERY HIGH SCHOOL

LOCATION: CALGARY, AB

BUILDER: LEAR CONSTRUCTION

The Montgomery School Replacement Project will see a new school built near the former school site. The grade 10-12 school will be able to support up to 1,000 students upon completion. School will be part of Foundations for the Future Charter Academy School Society.

**SUPPLIED:** Metal doors/frames, door hardware, coiling shutters, folding grilles, toilet partitions, lockers.





## DELTA HOTEL

LOCATION: THUNDER BAY, ON  
BUILDER: BNL CONTRACTING

Proudly standing on the northwestern shore of Lake Superior, the Delta Marriott in Thunder Bay is one of the only true waterfront hotels in town.

**SUPPLIED:** Wood doors and finish hardware, steel doors/frames, washroom accessories and specialties.



## WANUSKEWIN HERITAGE PARK

LOCATION: SASKATOON, SK

BUILDER: QUOREX CONSTRUCTION

Wanuskewin Heritage Park is a National Indigenous Heritage Site featuring a newly renovated expansion of their Interpretive Center, art gallery spaces and meeting rooms, as well as a refreshed restaurant, new playground and trail connections.

**SUPPLIED:** Architectural 2-1/4" oversized fir plank doors, steel doors, frames, and custom hardware.





## HOSPICE AT GLENGARDA

LOCATION: SASKATOON, SK

BUILDER: QUOREX CONSTRUCTION

The Hospice at Glengarda is Saskatchewan's first free-standing residential Hospice. It has 15 bright and beautiful individual rooms, providing 24-hour care for people requiring full-time, hands-on care in light of advancing, end-stage illness.

**SUPPLIED:** Sliding doors in patient rooms, steel and wood doors, frames, and hardware.





## THE WELLNESS INSTITUTE

LOCATION: WINNIPEG, MB

BUILDER: UMA ENGINEERING

The Wellness Institute Clinic is a rehabilitation and preventive health clinic that houses the clinical component of lifestyle medicine services.

**SUPPLIED:** Steel doors and frames, wood doors, and finish hardware.



## MISTAWASIS NĒHIYAWAK HIGH SCHOOL

LOCATION: MISTAWASIS FIRST NATION, SK

BUILDER: 3TWENTY MODULAR

Mistawasis Nêhiyawak High School was designed to meet the building and technological standards of new high schools in urban centres. The school has four classrooms and two additional flexible teaching spaces that are used primarily for STEM curriculum. The school is also equipped with a full commercial kitchen and cafeteria space for students and community members.

**SUPPLIED:** Steel and wood doors, frames, hardware, and washroom accessories.





## NIVERVILLE HIGH SCHOOL

LOCATION: NIVERVILLE, MB

BUILDER: RED LAKE CONSTRUCTION CO LTD.

Niverville High School is a new 70,000 sq.ft. facility designed to accommodate a student high school and a 74 unit childcare facility. The high school also includes a link providing access to a proposed town multiplex facility creating an educational, sporting, and cultural campus for the community.

**SUPPLIED:** Steel and wood doors, frames, finish hardware, and specialties.



## PENNER | CORPORATE HEAD OFFICE

LOCATION: SASKATOON, SK

BUILDER: QUOREX CONSTRUCTION

Penner's Saskatoon facility is a living showroom, featuring a range of architectural door and hardware options across a multitude of openings.

Connected to the offices is over 50,000ft<sup>2</sup> of state-of-the-art fabrication and warehousing.





## SOUTHEAST EVENT CENTRE

LOCATION: STEINBACH, MB

BUILDER: GRAHAM CONSTRUCTION

Southeast Event Centre is an all-in-one experience premier events venue. This multi-use facility can accommodate concerts, trade shows, ice sports, ceremonies, conferences, and gatherings of every kind.

**SUPPLIED:** Steel and wood doors, frames, finish hardware, and specialties.



## SECURITY BUILDING SUPPLIES

LOCATION: SASKATOON, SK

BUILDER: CON-TECH GENERAL CONTRACTORS

Veterans in the industry since 1968, supplying lumber and building materials to home builders, renovators, and general contractors. A 32,000 square foot building supplies warehouse and lumber yard with heated drive thru, coffee bar, boardroom and a large two-storey showroom.

**SUPPLIED:** Architectural wood and steel doors, frames, hardware, washroom accessories, floor grilles, and lockers.





## SASKATOON INTERNATIONAL AIRPORT

LOCATION: SASKATOON, SK  
INTERIOR RENOVATION

The Saskatoon Airport underwent a major renovation of the interior common areas in 2015, featuring new seating areas, washroom upgrades, refreshed office area, and new retail services.

**SUPPLIED:** Architectural wood doors, washroom partitions



## SPYHILL ARREST PROCESSING FACILITY

LOCATION: CALGARY, AB

BUILDER: CANA CONSTRUCTION

The Spyhill Services Centre is a new administrative and processing/holding facility for the City of Calgary and the Calgary Police Service (CPS), located in the northwest of Calgary. The multi-purpose facility features administrative office space, meeting and interview rooms, a fitness centre, full shower area, quiet rooms, BBQ patio area, prayer rooms, as well as 50 short-term holding cells and related processing facilities.

**SUPPLIED:** Metal and acoustic doors, frames, hardware, toilet partitions, washroom accessories, flagpoles, entrance mats, and visual boards.





## WESTJET WIDE BODY HANGAR

LOCATION: CALGARY, AB

BUILDER: CANA CONSTRUCTION

The 125,500 ft<sup>2</sup> WestJet Wide Body Hangar expands WestJet's operations by facilitating wide-body airplane operations, maintenance and storage. The hangar accommodates one 787-9 Dreamliner aircraft or up to four 737 aircraft.

**SUPPLIED:** Steel doors, frames, and hardware.



## SASKATCHEWAN PENITENTIARY

LOCATION: PRINCE ALBERT, SK

Saskatchewan Penitentiary is a medium security facility with maximum security areas and is located west of Prince Albert, Saskatchewan.

**SUPPLIED:** Steel doors and frames, hardware, detention doors, and specialties.





## STONEY CNG BUS STORAGE AND TRANSIT FACILITY

LOCATION: CALGARY, AB

BUILDER: PCL CONSTRUCTION

Calgary Transit's fleet of compressed-natural-gas (CNG) buses have a new, nearly 500,000-square-foot storage and maintenance garage to call home. Staff can keep the fleet in top shape with 36 maintenance bays, two detail cleaning bays and on-site compressed-natural-gas fueling infrastructure. The facility also supports diesel bus operations to accommodate the transition from a diesel to CNG fleet.

**SUPPLIED:** Steel doors, frames and finish hardware.



## ROQUETTE PEA PROCESSING PLANT

LOCATION: PORTAGE LA PRAIRIE, MB

BUILDER: GRAHAM CONSTRUCTION

The Roquette Pea Processing Plant, the largest pea protein facility in the world to date, aims to better meet the growing demand for pea protein around the world.

**SUPPLIED:** Steel doors, frames, and finish hardware.





## MANITOBA HYDRO BIPOLE III

LOCATION: KEEWATINOHK AND RIEL CONVERTER, MB  
BUILDER: MORTENSON CONSTRUCTION

Bipole III is a high-voltage direct current transmission line that delivers renewable energy to southern Manitoba, helping to reduce reliance on fossil fuels. The converter stations at both the Riel and Keewatinohk station sites were technical projects that required site-specific demands to be met for quality, security, and sound control. Providing welded mesh cages and large sound control openings required planning for manpower and equipment to install these doors with attention to quality and safety.

**SUPPLIED:** Hollow metal doors, wood doors, hardware specialties.





CORFLEX





**PENNER** | **DISCOVER PENNER** | DIVISION 10 | BUILDING SPECIALTIES



## MAILBOXES

Vertical or horizontal, recessed wall mounted mailboxes.

Applications: Apartments, condominiums, commercial or industrial spaces.





5 Door



12 Door

**PARCEL LOCKERS**

With the growth of on-line shopping, safe and secure parcel lockers are now a necessity in multi-family buildings. Both standard and custom configurations are available.

**TOILET PARTITIONS**

**hadrian®**



**SOLID PLASTIC**



**STAINLESS STEEL**



**POWDER COATED**



**PHENOLIC**

Custom colours and designs available.

Upgraded designer hardware in Matte Black or Brushed Stainless Steel.

Fireproof, waterproof and easy to clean.

25-year warranty.



## WASHROOM ACCESSORIES



Architects and engineers turn to Bradley for the industry's most innovative products specified for commercial washrooms and industrial safety applications.



From hand dryers and hair dryers, to vacuums, purifying fans and lighting, Dyson technology is engineered with your employees and guests in mind.



Frost has earned a reputation for manufacturing quality washroom products that offer both durability and value.



Bobrick is recognized as an industry leader in well-designed, value-oriented washroom accessories.



### ACCESS DOORS & HATCHES

Our roof hatch product offering includes a complete line of roof access and safety products.



### GARBAGE AND LAUNDRY CHUTES

Fire-rated standard chute doors for garbage, linen or recycling systems.





### TENANT STORAGE

Designed specifically for the condominium industry, storage lockers are available freestanding, floor to ceiling or hanging. Made of heavy duty welded wire mesh, the galvanized finish provides years of maintenance-free protection.



hadrian®

### LOCKERS

Hadrian offers durability beyond the restroom with heavy-duty steel lockers, designed for effective storage that complements any space.



**ERASABLE WHITE BOARDS**

Our dry erase white boards are equipped with a magnetic surface. Standard and custom dimensions available.



**CORK BOARDS & BILLBOARDS**

Our cork boards are perfect for displaying documents with pushpins. They are easy to use, simple to upkeep and are available in natural cork or a variety of colour options. The "wall-to-wall" option is also offered to transform a wall into a giant billboard up to 8 feet high and the width of your choice.





Amstel Manufacturing has been a Canadian leader in the door industry since the late 1960's. Since its inception, Amstel has been considered one of the premier companies in custom building closure systems



CornellCookson is the leader in custom built Overhead Rolling doors. Whether your needs include Rolling Service Doors, Security Doors, Fire Doors, Insulated Garage Doors or Security Grilles, they have the right fit for you.



Pentagon has over 20 years of experience with security shutters and closure systems, as well as being a leading manufacturer of security shutters and retractable screens.



CrossingGard Grille® with ThreatProtect™ is made for schools, higher education institutions, healthcare facilities, and commercial/industrial applications that need a solution for safe egress and public access control.

## FOOT GRILESS & FLOOR MATS



### MAT SYSTEMS

Choose entrance mat systems that perform and provide lasting durability by helping to stop dirt and moisture from reaching your interior floors.



### GRID SYSTEMS

Entrance grids are the ultimate dirt-trapping systems featuring superior fall-through to keep debris from being tracked into your building.



### STAINLESS STEEL GRIDS

As pedestrians enter your building, stainless steel grids provide excellent scraping performance with high-tech yet durable aesthetic.



### SPECIALTY FLOORING

The designer's choice for entrance flooring. It not only performs, it enhances your entrance and the critical first impression it makes.







**VEVOR**

## PET WASH STATIONS

Pet wash stations are being added in many multi-family projects. There are several models and sizes to choose from. These are great selling incentives for every pet-friendly community, and reduce the overall plumbing maintenance on the building.



62" Stainless Steel  
Pet Bathing Station  
with Ramp



50" Stainless Steel  
Pet Bathing Station  
with Stairs



50" Stainless Steel Pet  
Bathing Station with  
Height Adjustment



### RUBBERMAID WIRE SHELVING

Rubbermaid carries the standard for high-quality steel epoxy-coated wire shelving. Durable and reliable, it has become the norm in most new homes. White or Satin Nickel finish.



### MOULDINGS

We source from a variety of Canadian Vendors to provide high-quality mouldings to suit your products needs.





**BIKE RACKS**

A Canadian-made product, Cora Bike Racks will support 2 to 10 bikes. Different lengths, colours and finishes are available, all for the purpose of security and safety.

**EXPO SERIES**



**W4508**



**W5808**



**W7510**

**WALL MOUNTS**



**VWM002** (Hanging Bikes)



**HWM002**



**LWM002**

**STAPLE RACK**



**SRA002** (No Hanger)  
The Staple



**SRC002**  
The Tree



**SRE002**  
The Oval



## CORFLEX

### MOVABLE PARTITIONS

Enhance the look of your rooms by opting for the installation of movable partitions. An impeccable finish and a rendering that meets your expectations.



### ACOUSTIC TREATMENT

We reinvent the world of acoustic processing to push the boundaries of design and engineering, while promoting your productivity.





## **GX - ULTRA ACOUSTIC MOVABLE GLASS PARTITIONS**

### **Innovative System**

GX is the glass movable partition system offering the best acoustical performance on the market. Its full-surface glass design – with no apparent frame – combines neat aesthetics while allowing an incomparable intimacy.

Using self-guided carriers and a curved intersection track system, the GX's glass panels are very easy to move and require low maintenance.



## **HYDRAULIC DOORS**

The hydraulic door system is synonymous with state-of-the-art technology, as well as being a product that meets the most complex requirements in terms of engineering.







| PENNER | DISCOVER PENNER | DIVISION 8 | OPENINGS |





## WEST FOUR ALUMINUM

Penner has invested in the future with our West Four Aluminum program. Our Edmonton facility has undergone a major plant retrofit, with the addition of a line machine and robotic fixtures.





# Novatech® PATIO DOORS





## THE STUDIO PATIO DOOR

The Studio Patio Door exceeds industry performance standards. Ideal for high-rise projects, this door is built to withstand the weather and high winds at the top. Studio is a flexible aluminum patio door designed for architectural uses with multiple customization options.

**Available Finishes:**



Clear  
Anodized



Commercial  
Brown



Black



**M** Madero

**EXTERIOR DOORS**





## BALCONY STORAGE | FRONT ENTRY | GARAGE ENTRY

Madero's door systems are tailored to withstand the extreme Canadian climate. A versatile program featuring exterior door openings using steel and fiberglass slabs, partnered with wood, composite or aluminum clad frames. Maintenance-free and factory finished options available.





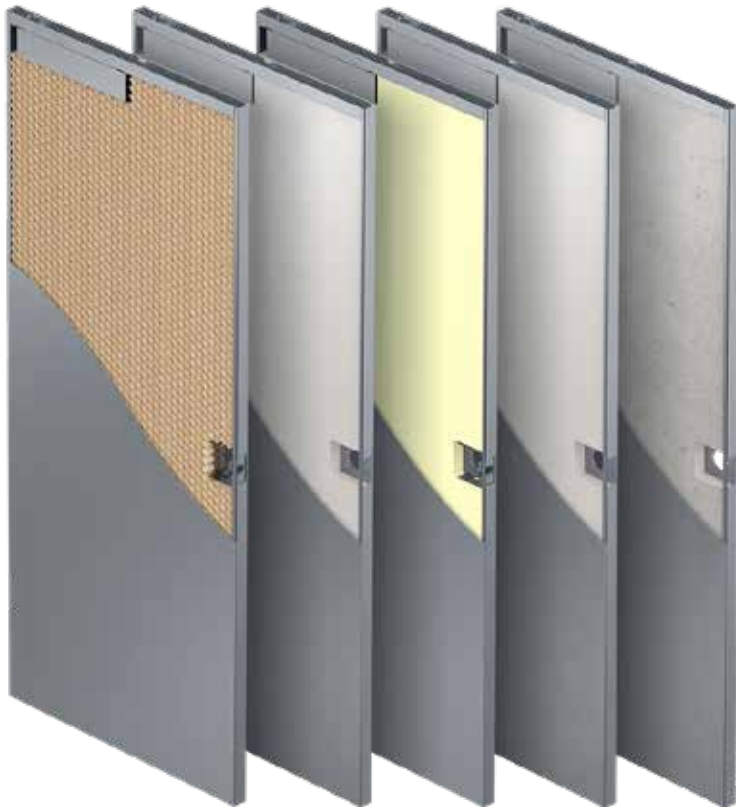

## HOLLOW METAL DOORS & FRAMES

**DAYBAR**



**VISION**

HOLLOW METAL LIMITED

Performance Tested  
Hardware Compatibility  
Sustainable Design

## GLAZING OPTIONS



**Clear, Clear Low E** with Argon.

**Rockglass** is lighter, stronger and more impact resistant than regular glass.  
Shatter Proof | Impact Resistant | Anti-Intrusion

**Pyran** is a fire resistant glazing made from borosilicate - single safety glass.

**Pyran S** is a double glazed unit offering extra insulation and protection.

**Protect3** replaces GPW glass. It is a 1/4" (6.8mm") thick glazing material consisting of fire rated wire glass with a factory applied fire rated and impact safety rated film.



**VISION**  
HOLLOW METAL LIMITED

**DAYBAR**



## HOLLOW METAL DOORS & FRAMES

### EXPANDABLE EF-K FRAME SERIES (REVERSIBLE HANDING)

The EF-K Series are an ideal solution for commercial building applications and retrofit work on existing buildings, especially when existing wall types are unknown or vary throughout the project.

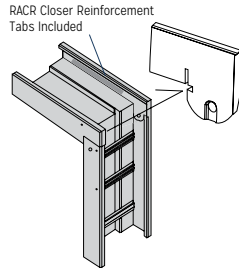

### EXPANDABLE EF FRAME SERIES (NON-REVERSIBLE)

EF Series features a two-piece frame component, held together with a bracket system and spot welded to the frame material, allowing the jamb depth to be reduced or increased based on site conditions.

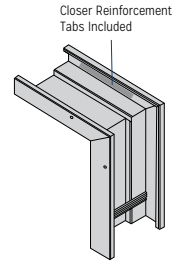

### K SERIES DRYWALL FRAMES

K Series Standard are for use with 1-3/4" steel or wood doors. They are available in a variety of standard and non-standard sizes for use in a broad range of wood or metal stud wall constructions.

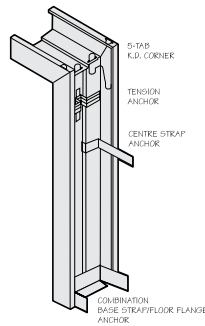

### WELDED FRAMES

Welded frames are intended for installation during wall construction and are recommended for a wide variety of interior or exterior commercial, industrial, and residential applications. They are brake-formed for tight fitting mitres.

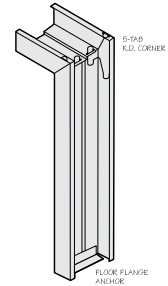

**GASKET-READY PROFILE  
STEEL DOOR FRAME.**



**CASING-READY FLUSH-  
FIT STEEL DOOR FRAMES.**



**PREMIUM STEEL DOOR  
FRAMES FOR ONE-PIECE OR  
WELDED APPLICATIONS.**



LAMBTON  
Doors  
WOOD DOOR AND JAMB SOLUTIONS

**FORTE**  
OPENING SOLUTIONS

*(Formerly Masonite Architectural)*



## ARCHITECTURAL WOOD DOORS



The Baillargeon brand has been specializing in the design, manufacture and marketing of architectural, institutional, fire and commercial wood doors and jambs in Canada since 1985.

When your ideas are packed with innovations, when your projects require custom solutions or when your creativity demands something much more than run-of-the-mill... anything is possible with Baillargeon! This custom approach opens up a world of potential. Have a complicated door design? We take pride in making the seemingly impossible — possible.

Baillargeon branded doors and frames can offer extraordinary detail to your project, are custom fit to your opening and backed by the Baillargeon compliance guaranty.



### HIGH-QUALITY INTERIOR WOOD DOORS AND FRAMES

At LAMBTON DOORS, our mission is to develop and manufacture high-quality, value-added interior wood doors and frames for our North American commercial, architectural and institutional clients.

To meet our clients' needs and respond to new market opportunities, we focus on the quality of our human resources, use state-of-the-art technologies and offer harmoniously designed, environmentally-friendly products.

LAMBTON DOORS manufactures 5-ply wood doors and frames for several applications: fire-rated doors, acoustical doors, lead-lined doors, bullet-resistant doors, oversized doors and others.





## 20M MOULDED PANEL WOOD DOORS

The Interior program features a primed product ready for painting. Undersized to allow compatibility with Hollow Metal or Fire Rated Wood Jamb. 5 year limited warranty.



Shaker Doors | West End Collection | Core Moulded Panel



## 20M FIRE RATED FRAMES

Fire rated doors are often used for house and garage applications or as entrances to Multi-Family dwellings. All 20 Minute fire rated frames are available in 4-9/16", 6-3/4", 7-7/8" or 9". Custom upon request. Machined and labelled in factory - standard sizes will see the door slab 1/4" undersized in width, and 7/8" in height.



## UP TO 180 MINUTE FIRE RATED FRAMES

### EXPANDABLE EF FRAME SERIES

(Non-Reversible)

EF Series features a two-piece frame component, held together with a bracket system and spot welded to the frame material, allowing the jamb depth to be reduced or increased based on site conditions.



### WELDED FRAMES

Welded frames are intended for installation during wall construction and are recommended for a wide variety of interior or exterior commercial, industrial, and residential applications. They are brake-formed for tight fitting mitres that are welded and ground to achieve a smooth appearance.

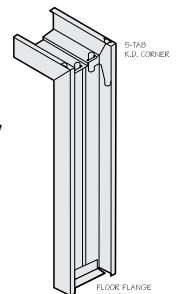



**5PK**  
5 Panel  
Smooth Shaker



**3PEK**  
3 Panel Equal  
Smooth Shaker



**1PK**  
1 Panel  
Smooth Shaker  
Lincoln Park



**3PCK**  
3 Panel Craftsman  
Smooth Shaker  
Winslow



**2PK**  
2 Panel  
Smooth Shaker  
Logan

**SHAKER DOORS**

Shaker moulded panel doors feature stile and rail inspired designs with clean and simple lines that provide a distinctive look for any interior décor. For increased privacy and sound reduction, choose the solid core option.

**MOULDED PANEL DOORS**

Moulded Panel doors are a major influence in residential construction. The Madero Interior program features the three most popular designs - 5 Panel Smooth, 2 Panel Smooth and 6 Panel Textured.



**5PSM**  
5 Panel Smooth  
6 Panel 96"  
Riverside

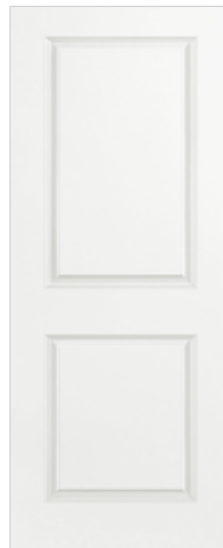

**2PSM**  
2 Panel Smooth  
Carrara



**6PTX**  
6 Panel Textured  
Colonist



**Red Oak**  
Plain Sliced



**Natural Birch**  
Rotary Cut



**Lauan**  
Hardwood



**Marquis Oak**  
Factory Pre-finished



**Primed Hardboard (MDF)**

**FLUSH PANEL**

Flush panel doors provide a modern architectural look with natural beauty for smaller budget renovations. Choose from hardboard, wood veneer or pre-finished Marquis Oak.

**WEST END COLLECTION**

The West End Collection features metropolitan inspired designs with bold graphic lines. For increased privacy and sound reduction, choose the embossed slab option.

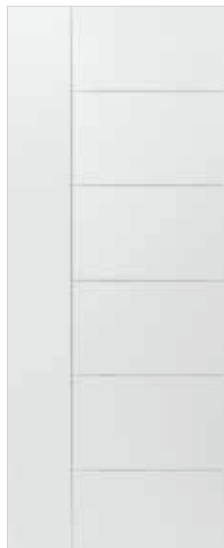

**Berkley**  
6 Panel Equal with  
1 Vertical Panel

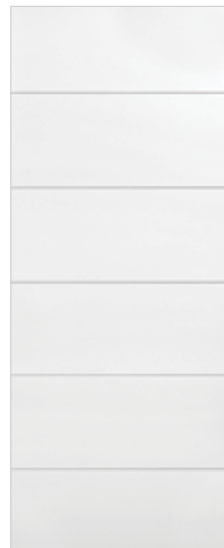

**Melrose**  
6 Panel Equal  
(Not recommended  
for double doors)

**DOOR PRE-FINISHING**

The primary goal for every construction project - on time and on budget. More and more projects are utilizing the services of in-house painting, and in-house hardware installation.







## SPECIALTY INTERIOR DOORS

### GLASS PANEL DOORS

Brighten any room with glass interior French Doors. Available in primed MDF engineered wood, with Clear Tempered or White Laminated glass. Can be painted to match any decor.



## RENIN

### EURO 3-LITE | BYPASS DOOR

The European-inspired, 3-lite sliding bypass closet door system showcases frosted glass for translucent light transmission and privacy.



**WOOD VENEER STILE AND RAIL DOORS**



**BARN DOOR & HARDWARE SYSTEMS**



### BACK-TO-BACK ROUND DOOR PULL & FLUSH SET

This door pull set is an excellent choice for barn doors. It includes a standout 18" round pull with 1" diameter, paired with a 15" x 2-1/4" flush pull.



**KN Crowder**

**ROCKWOOD**  
**ASSA ABLOY**



## ARCHITECTURAL PULLS | RESIDENTIAL INTERIOR



### MEGAMET™

Effortless style in a simple design allow these pulls to offer a pleasing, functional, modern solution to any entry door.



### NOIRMET™

Make a bold statement with the subtlety of black, hard-coat anodized grips contrasted with a compelling selection of end and mounting post finishes.

## RECTANGULAR POCKET DOOR MORTISE LOCKS

The Modern Rectangular Pocket Door Mortise Lock offers a clean, contemporary trim style and high-quality lock for your sliding interior doors. This item is a well-crafted mortise lock with an integrated push button activated edge pull, and is offered in keyed, privacy, passage or dummy applications.

- Sold as complete set.
- Includes screws and strike plate.
- Must specify door thickness for Keyed and Privacy functions.  
Plates are 1/16" thick.



EMTEK.

**PENKO**  
ASSA ABLOY



### SDL SERIES

The SDL Series Privacy Barn Door Lock is designed for surface mounted sliding doors. It is installed on the jamb wall facing the opening to offer simple comfort and privacy when needed.

- For surface mounted side wall mounted sliding doors.
- Handing reversible in the field.
- Privacy function.
- Includes Emergency Release Key.
- For doors with 3/8" - 3/4" clearance between the wall or frame and door face.
- ADA option available.
- Doors can be prepped in the field.
- Available in Black Graphite and Polished Stainless Steel.
- Width 3-9/16" Height 1-7/8" Projection 9/16".



## WEST FOUR

Aluminum

### WEST FOUR ALUMINUM

For common area meeting rooms, gymnasiums and other centralized facilities. Aluminum wall systems are functional and structural. Custom made to your specifications.

## WALL SYSTEMS SPECIFICATIONS



Horizontal | Midrail

*NOTE: Custom midrail placement is available.*



Vertical | Midrail

*NOTE: Custom midrail placement is available.*



Seamless | Silicone Joints



Vertical and Horizontal | Midrail

*NOTE: Custom midrail placement is available.*

## DOOR LEAF TYPES



Glass Wall with Swing Door



Sliding with Aluminum Door

### Available Frame Finishes:



Clear Anodized



Dark Bronze Anodized



Powder Coated Black

### Glass Options:

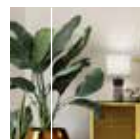

Clear Tempered



Frosted Tempered





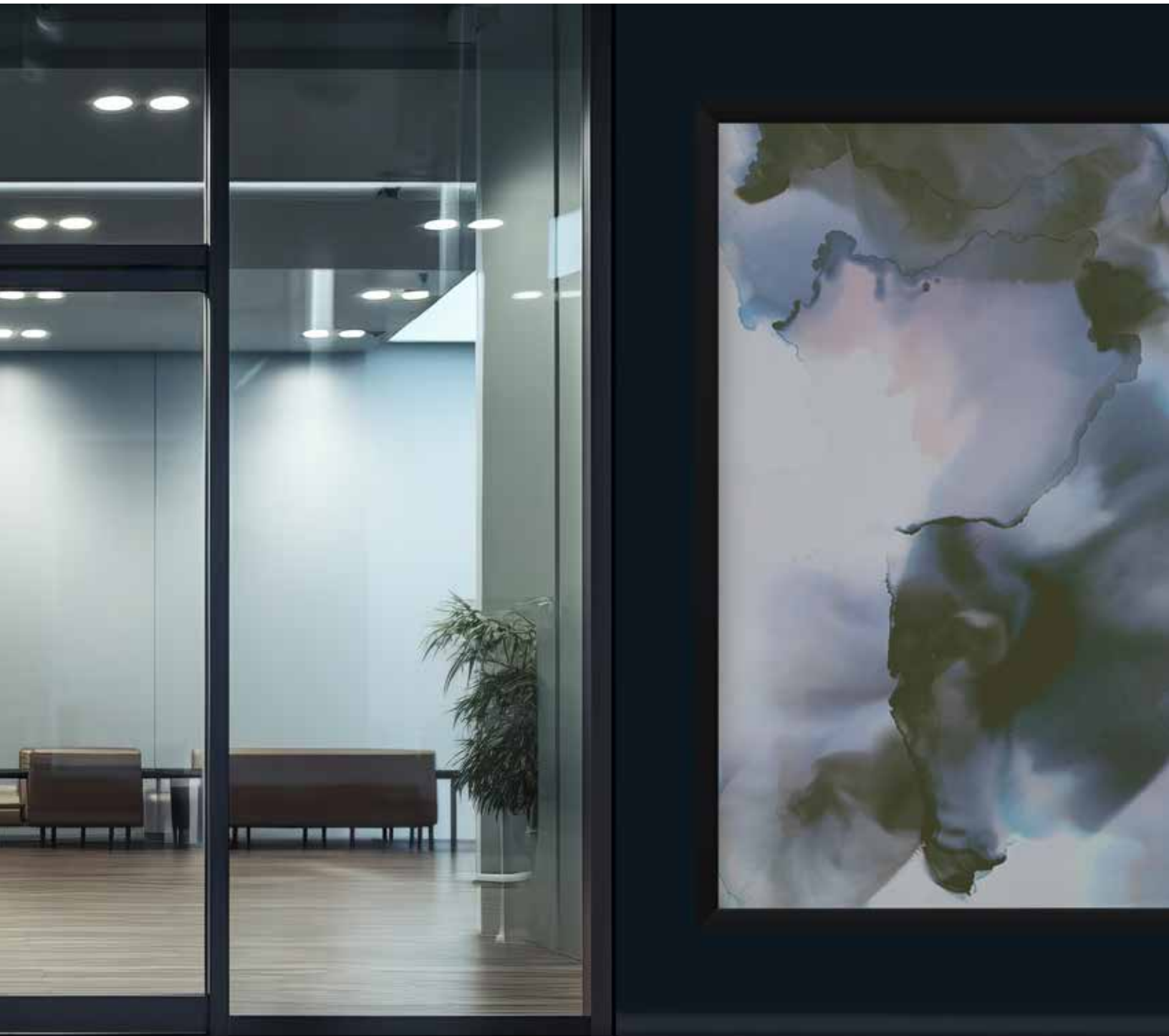

## **AUTOMATIC DOOR OPERATORS**

Record's swing door operators are sleek and unobtrusive. Known for quiet operation, easy installation and reliability that outlasts the competition. Swing door operators are ideal for both existing and new installations.

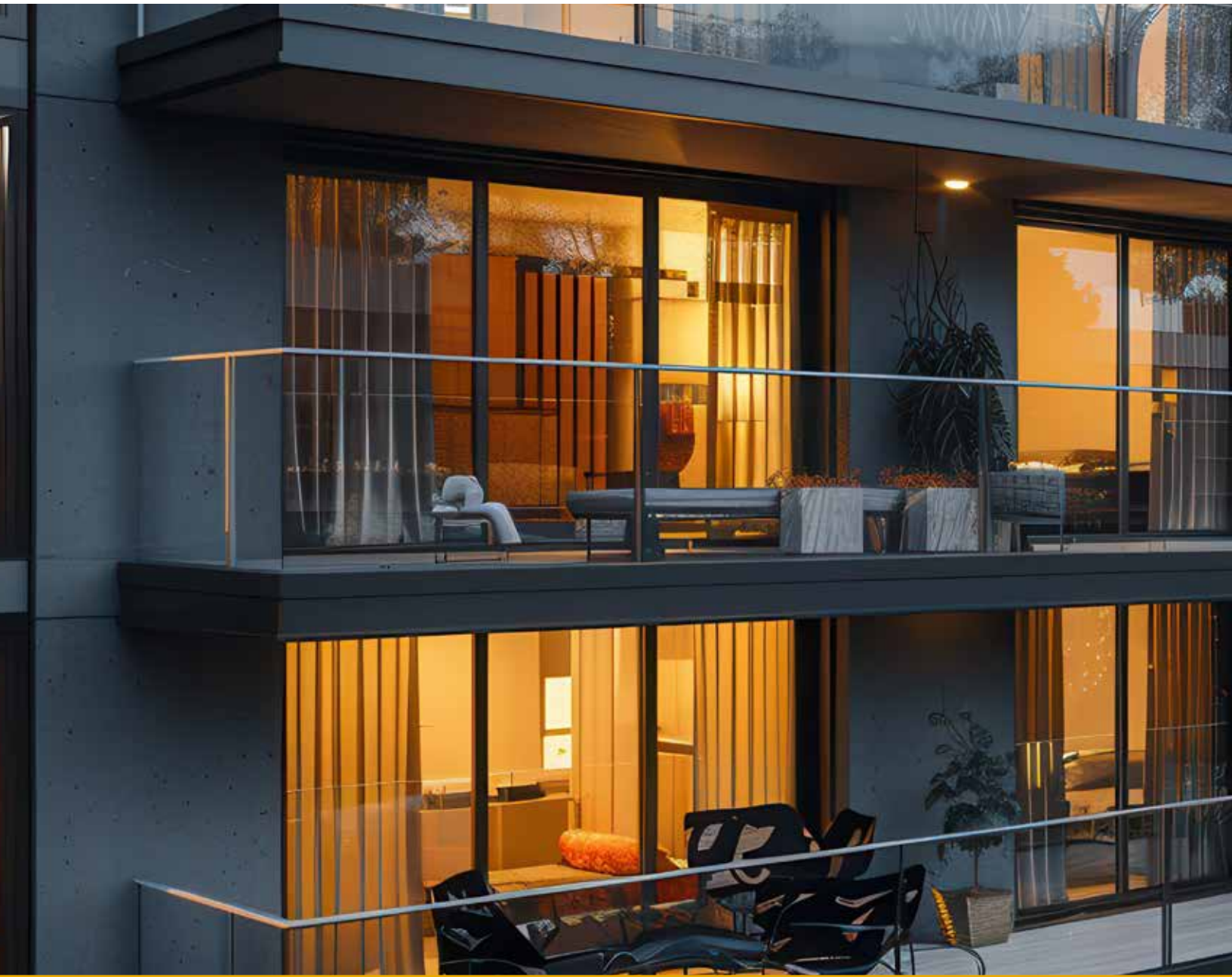

## ACCENTRA

## ASSA ABLOY

Assa Abloy Accentra™ offers a host of commercial-grade door hardware, including an extensive range of mortise and cylindrical locks, exit devices, door closers, electromechanical products and keyed systems.



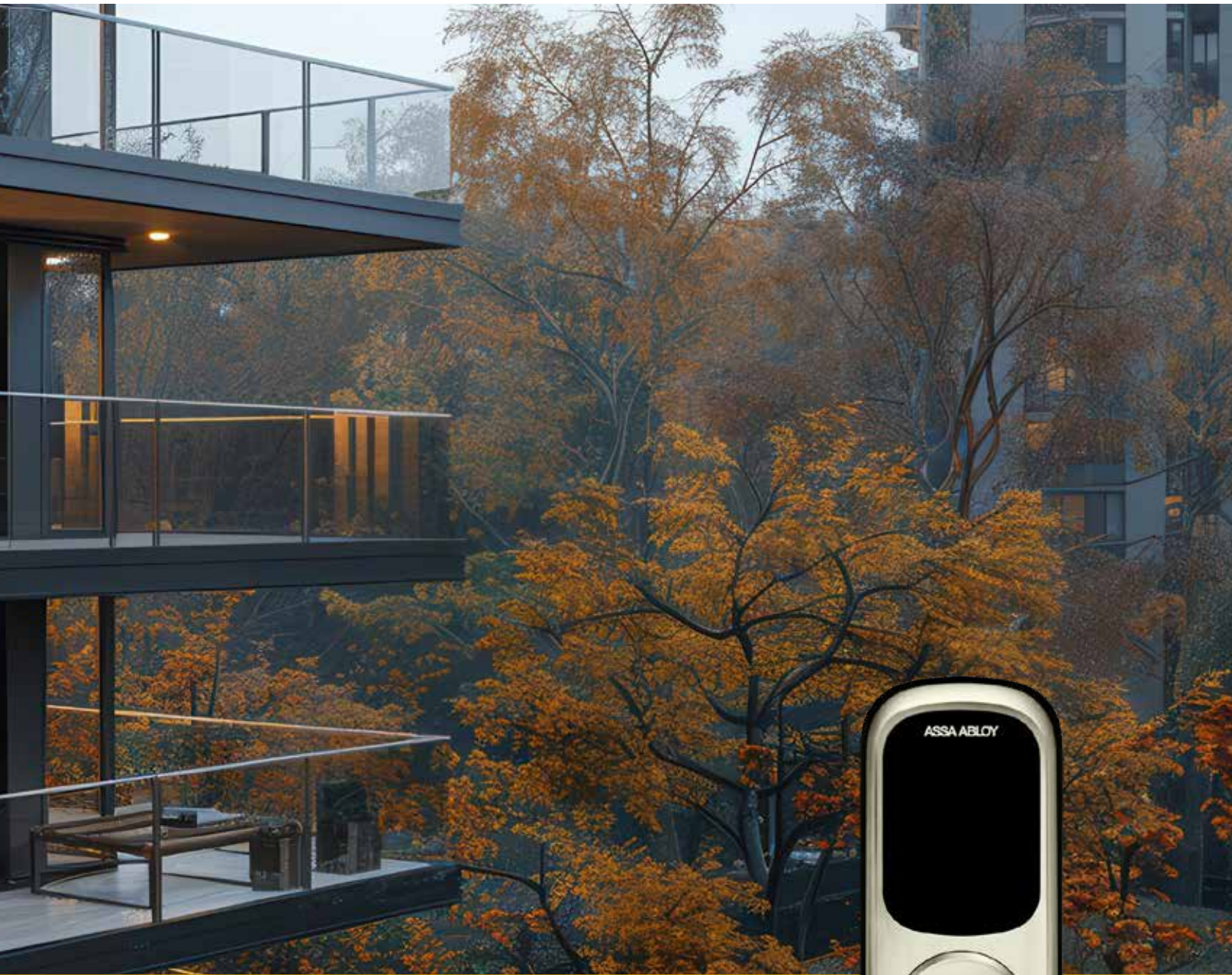

### NEXTOUCH® INTERCONNECTED

Assa Abloy Accentra™ nexTouch® Interconnected lock combines electronic deadbolts with the convenience of a passage lever for panic-proof egress. From the inside, both the latch-bolt and the deadbolt are retracted simultaneously in a single motion for a quick and easy exit. Choose from 12 lever styles.

#### Available Finishes:



Oil Rubbed  
Bronze, Permanent



Satin Nickel Plated,  
Clear Coat



Black Suede,  
Powder Coated

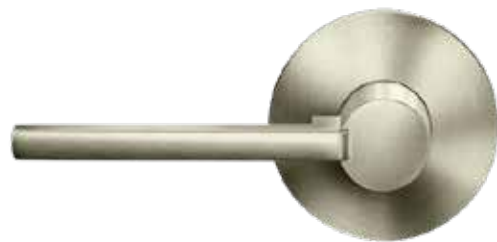



**ALLEGION™** 

**ENGAGE™ FOR ACCESS CONTROL**



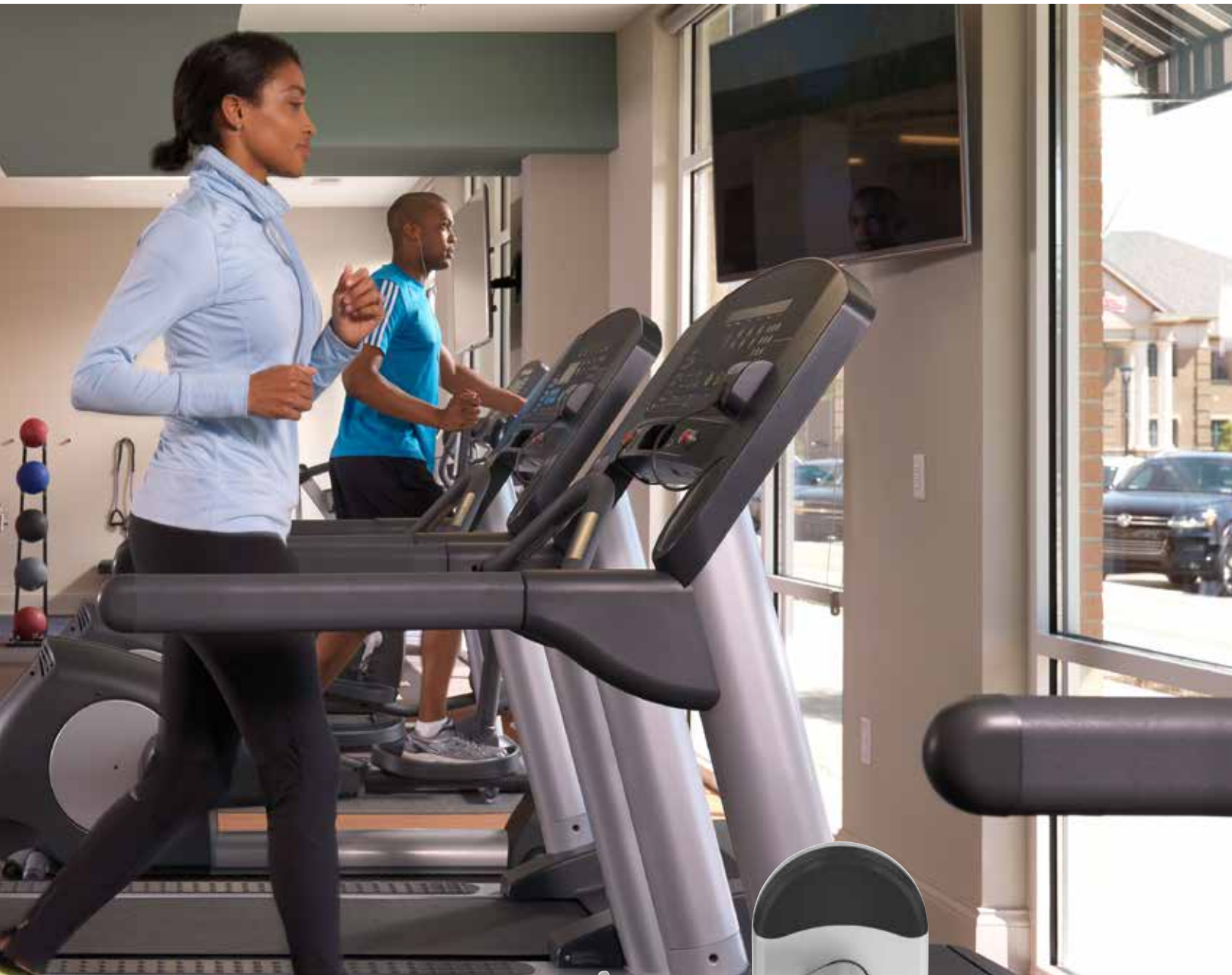

## SCHLAGE NDE MOBILE ENABLED WIRELESS CYLINDRICAL LOCK

- Refined design for doors with cylindrical prep.
- Includes interior push button with indication for additional functionality.
- Compatible with Bluetooth and NFC mobile, smart and proximity credentials.







ALLEGION™  

## ALLEGION PRODUCTS

Deliver the value of electronic security with wireless solutions to more doors, more ways.

Schlage Control comes standard with ENGAGE™ technology, which provides connectivity and lock management for facilities staff through the ENGAGE app. This technology also allows residents to gain access using sophisticated smart technology. From a smart phone, tablet or computer, you can quickly add users, view a history of access, get data, receive alerts and more.

### SCHLAGE XE360 SERIES WIRELESS MORTISE LOCK

The Schlage XE360 series of wireless locks from Allegion US is a keyless entry system designed specifically for use in multifamily properties. The locks feature a slim silhouette and modern-style handle in a choice of three finishes. The locks can be used both on resident doors and in common areas.



Optimized for Multi-Family



Greenwich

Addison

### SCHLAGE LE MOBILE ENABLED WIRELESS MORTISE LOCK

- Elegant design for doors with mortise prep.
- Choose Greenwich or Addison trim.
- Options include mortise and mortise deadbolt.
- Compatible with Bluetooth and NFC mobile, smart and proximity credentials.

### SCHLAGE CONTROL MOBILE ENABLED SMART DEADBOLT AND INTERCONNECTED LOCK

- Smart deadbolt options for resident entries.
- Choose Greenwich or Addison trim options.
- Interconnected design enables single-motion egress.
- Compatible with Bluetooth mobile and smart credentials.



Greenwich

Addison

Greenwich

Addison



### **ARCHITECTURAL, COMMERCIAL & RESIDENTIAL HARDWARE**

Locksets, to panic hardware to door closers, Penner sources from all primary hardware brands. We have solutions for 'light' commercial to 'high' performance architectural applications.





**WEISER**

## WHY SAFELOCK BY WEISER?

- Safelock meets the ANSI/BHMA Grade 3 performance standards for residential hardware. All of our locks pass an extensive series of heavy-duty, intense testing procedures to ensure quality and performance.
- Safelock is a cost-effective door hardware solution for builders. It combines trusted security and performance with traditional and contemporary styles, finishes that will enhance any home.



Daylon - 3 Finishes



Reminy - 2 Finishes

## KEY CONTROL DEADBOLT

The Key Control Deadbolt is the perfect solution for multi-family dwellings and rental complexes. Features a property manager cylinder and tenant cylinder so both users have individual access to the same property. The deadbolt features SmartKey re-key technology so either cylinder can be rekeyed in seconds.





## SCHLAGE KEYED LEVERS & DEADBOLT

Must be specified to contain UL rated latch to comply with 20 minute fire rating requirements.

- Fits all standard door preps, with lever designs reversible in-field.
- Installation is easy with posts that guide the screw into the proper location.
- Master keying and construction keying available upon request.

### LEVERS & KNOBS F-SERIES



**Broadway Family**

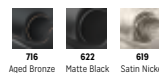

716 Aged Bronze 622 Matte Black 619 Satin Nickel

### DECORATIVE COLLECTIONS



**Latitude | Collins**



622 Matte Black 619 Satin Nickel

### DEADBOLTS



**B60F**

## SCHLAGE CONTROL™ SMART LOCKS

Schlage Control Smart Deadbolt locks are ideal for multi-family communities, senior living communities and student housing.

### Benefits:

- Increases efficiency of property operations.
- Easy Installation.
- No cylinder design eliminates traditional keys.



**BE467F GRW 619**  
Greenwich trim with Broadway lever in Satin Nickel.  
Lever sold separately



## Industry Associations



### CONTACT

For Service & Installation, please call or email:

**1-888-871-3667**  
**service@pennerdoors.com**

For orders and quick service please email:

**orders@pennerdoors.com**

For project estimates please email:

**estimating@pennerdoors.com**